

Model "PINA-FIX" floor mounted double dance bar support

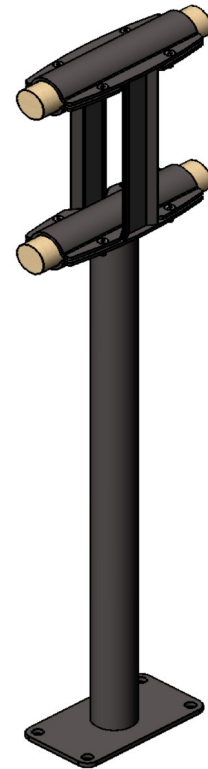
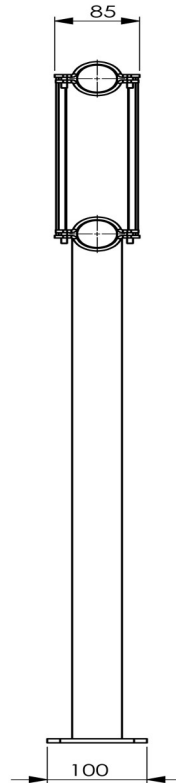
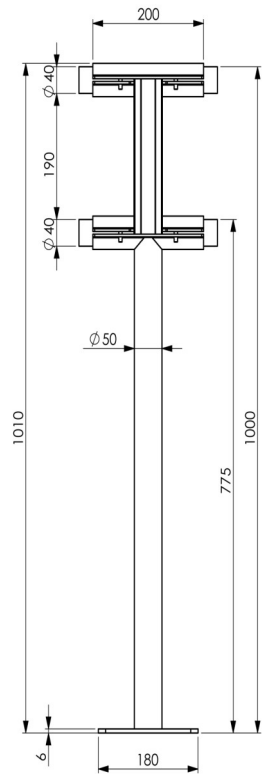

Technical Details

Dimensions:

- Height
 - floor to top of the upper bar 1010 mm
 - floor to top of the lower bar 775 mm
- Distance between the bars 190 mm
- Diameter of upright 50 mm
- Base (length x width x thickness) 180 x 100 x 6 mm

Features:

- Weight: 5.75 kg
- Material: upright and base out of steel
- Finishing: epoxy coated silver

Included:

- 4 Hexagon screw anchors of M 10 x 70

We recommend a maximum distance between supports of 2 m.
The PINA-FIX is designed for bars with a diameter of 40 mm.
Wooden bars are not included.

